

Z-Parts House / Suspension Restoration
 319 Motor City Court
 Modesto, CA 95356
 (209) 578-5101

NOTE: When Measuring What Size Bushing You Need Please Use A Dial Caliper When Making Your Measurements. Do Not Use A Ruler!
Fractional & Millimeter Sizes Listed Are Only Estimates
 ALL Dimensions Subject to +/- 0.015"

Bushing #	A Bushings I.D.	B Barrel O.D.	C Flange OD	D Length	E Flange Thickness	Sleeve
2002 95A	3/4" .745" 18.9mm	1-1/2" 1.508" 38.3mm	1-61/64" 1.950" 49.5mm	1-7/16" 1.441" 36.6mm	1/2" .497" 12.6mm	#08 (9/16" Bolt) #45 (1/2" Bolt)
2004 95A	3/4" .746" 18.9mm	1-1/2" 1.507" 38.3mm	1-31/32" 1.970" 50mm	1-15/32" 1.461" 37.1mm	1/4" .254" 6.5mm	#08 (9/16" Bolt) #45 (1/2" Bolt)
2006 95A	3/4" .745" 18.9mm	1-1/2" 1.510" 38.4mm	1-15/16" 1.90" 48.3mm	1-1/2" 1.475" 37.5mm	7/32" .210" 5.3mm	#09 (9/16" Bolt) #159 (1/2" Bolt)
2008 95A	5/8" .623" 15.8mm	1-3/32" 1.105" 28mm	1-1/2" 1.496" 38mm	1-3/4" 1.727" 43.9mm	1/4" .256" 6.5mm	#160 (1/2" Bolt)
2009 95A	3/4" .747" 19mm	1-3/8" 1.382" 35.1mm	1-11/16" 1.692" 43mm	1-1/2" 1.496" 38mm	3/8" .334" 8.5mm	#08 (9/16" Bolt) #45 (1/2" Bolt)
2010 95A	11/16" .694" 17.6mm	1-1/8" 1.126" 28.6mm	1-15/32" 1.463" 37.2mm	1-13/16" 1.826" 46.4mm	5/8" .615" 15.6mm	#502 (9/16" Bolt)
2013 95T	3/4" .745" 18.9mm	2" 2.005" 51mm	2-1/2" 2.498" 63.5mm	1-7/8" 1.862" 47.3mm	5/8" .617" 15.7mm	#01 (1/2" Bolt) #120 (9/16" Bolt)
2014 95A	3/4" .747" 19mm	2" 2.00" 50.8mm	2-1/2" 2.515" 63.9mm	1-3/4" 1.762" 44.8mm	17/32" .520" 13.2mm	#09 (9/16" Bolt) #159 (1/2" Bolt)
2016 95A	9/16" .557" 14.2mm	1-19/32" 1.613" 41mm	2" 2.011" 51.1	1-9/16" 1.685" 42.8mm	1/2" .459" 11.7mm	
2017 95A	9/16" .557" 14.2mm	1-19/32" 1.60" 40.7mm	2-1/2" 2.50" 63.5mm	1-9/16" 1.689" 42.9mm	1/4" 0.309" 7.9mm	
2020 95A	3/4" .761" 19.3mm	1-3/8" 1.402" 35.6mm	1-11/16" 1.705" 43.3mm	1-1/2" 1.473" 37.4mm	1/4" .246" 6.2mm	#08 (9/16" Bolt) #45 (1/2" Bolt)

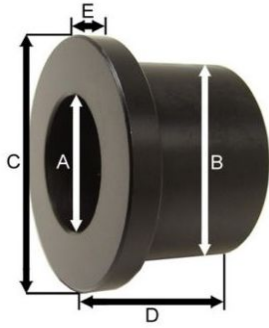

NOTE: When Measuring What Size Bushing You Need Please Use A Dial Caliper When Making Your Measurements. Do Not Use A Ruler! Fractional & Millimeter Sizes Listed Are Only Estimates

****ALL Dimensions Subject to +/- 0.015"****

Bushing #	A Bushing I.D.	B Barrel O.D.	C Flange OD	D Length	E Flange Thickness	Sleeve
2025 95A	0.875" 22.2mm	1.518" 38.6mm	1.830" 46.5mm	1.516" 38.5mm	0.309 7.9mm	
2026 95A	.563" 14.3mm	1.013" 25.7mm	1.325" 33.7mm	1.434" 26.4mm	.214" 5.4mm	
2027 95A	.753" 19.1mm	1.526" 38.8mm	1.952" 49.6mm	1.343" 34.1mm	.119" 3mm	
2035 95A	.621" 15.8mm	1.124" 28.6mm	1.500" 38.1mm	1.520" 38.6mm	.207" 5.3mm	
2039 95A	.703" 17.9mm	1.188" 30.2mm	1.460" 37.1mm	2.043" 51.9mm	.252" 6.4mm	
2041 95A	.746" 18.9mm	1.555" 39.5mm	2.049" 52mm	1.340" 34mm	.200" 5.1mm	
2043 95A	.620" 15.8mm	1.132" 28.6mm	1.450" 36.8mm	1.70" 43.2mm	.491" 12.5mm	
2045 95A	.623" 15.8mm	1.608" 40.8mm	2.016" 51.2mm	1.156" 29.4mm	.290" 7.3mm	
2046 95A	.498" 15.8mm	1.195" 30.4mm	1.496" 38mm	1.040" 26.4mm	.717" 4.3mm	
2047 95A	.747" 18.9mm	1.261" 32mm	1.488" 37.8mm	1.436" 36.5mm	.203" 5.2mm	
2050 95A	3/4" 19mm	1-1/4" 31.9mm	1-3/4" 47.3mm	1-23/32" 43.5mm	1/4" 5.9mm	#159 (1/2" Bolt) #09 (9/16" Bolt)

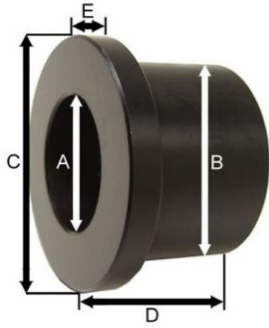

*NOTE: When Measuring What Size Bushing You Need Please Use A Dial Caliper When Making Your Measurements. Do Not Use A Ruler!
Fractional & Millimeter Sizes Listed Are Only Estimates*

*****ALL Dimensions Subject to +/- 0.015"*****

Bushing #	A Bushing I.D.	B Barrel O.D.	C Flange OD	D Length	E Flange Thickness	Sleeve
2051 95A	3/4" 0.746 19mm	1-3/8" 1.361" 34.6mm	1-7/8" 1.749" 44.4mm	1-11/16" 1.719" 43.7mm	1/4" .323" 8.2mm	
2054 95A	.870" 22.1mm	1.624" 41.3mm	2.496" 63.4mm	1.718" 43.6mm	.236" 6mm	
2055 95A	.735" 18.7mm	1.987" 50.5mm	2.504" 63.6mm	1.716" 43.6mm	.225" 5.7mm	
2056 95A	.748" 19mm	1.134" 28.8mm	1.50" 38.1mm	1.360" 34.6mm	.240" 6.1mm	
2060 95A	1/2" .500" 12.7mm	7/8" .872" 22.1mm	1-1/8" 1.158" 29.4mm	1-1/8" 1.137" 28.9mm	1/8" .169" 4.3mm	
2068 95A	.620" 15.8mm	1.136" 28.7mm	1.453" 36.9mm	1.259" 32mm	.280" 7.1mm	
2070 95A	.871" 22.1mm	1.710" 43.4mm	2.503" 63.6mm	.881" 22.4mm	0.214 5.4mm	
2072 95A	.746" 19mm	1.260" 32mm	1.740" 44.2mm	1.670" 42.4mm	.190"	
2076 95A	3/4" .750" 19mm	1-3/4" 1.762" 44.8mm	2-7/32" 2.200" 55.9mm	1-1/2" 1.488" 37.8mm	1/4" .250" 6.4mm	#45 (1/2" Bolt) #08 (9/16" Bolt)
2077 95A	.694" 17.6mm	1.129" 28.7mm	1.453" 36.9mm	1.757" 44.6mm	.545" 13.8mm	
2080 95A	1/2" .494" 12.6mm	7/8" .865" 22mm	1-1/4" 1.221" 31mm	1-1/2" 1.508" 38.3mm	1/4" .276" 7mm	

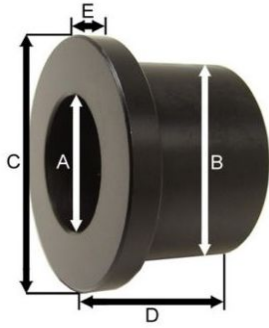

NOTE: When Measuring What Size Bushing You Need Please Use A Dial Caliper When Making Your Measurements. Do Not Use A Ruler! Fractional & Millimeter Sizes Listed Are Only Estimates

*****ALL Dimensions Subject to +/- 0.015"*****

Bushing #	A Bushing I.D.	B Barrel O.D.	C Flange OD	D Length	E Flange Thickness	Sleeve
2086	.750" 19mm	1.250" 31.8mm	1.772" 45mm	1.455" 37mm	.235" 6mm	
2088	.750" 19mm	1.135" 28.8mm	1.761" 44.7mm	3.005" 76.3mm	.230" 5.9mm	
2092	.705" 17.9mm	1.200" 30.5mm	1.569" 40mm	1.717" 43.6mm	.167" 4.3mm	
2093	.750" 19mm	1.510" 38.4mm	1.750" 44.5mm	1.250" 31.8mm	.250" 6.4mm	
2099	.746" 19mm	1.505" 38.2mm	1.890" 48mm	1.337" 34mm	.230" 5.9mm	
2101	.750" 19mm	1.690" 43mm	2.058" 52.3mm	1.470" 37.3mm	.320" 8.1mm	
2102	.750" 19mm	1.545" 39.2mm	1.881" 47.8mm	1.470" 37.3mm	.320" 8.1mm	
2104	.687" 17.6mm	1.134" 28.8mm	1.490" 37.9mm	1.675" 42.6mm	.255" 6.5mm	
2108	.875" 22.2mm	1.260" 32mm	2.76" 70.1mm	1.110" 28.2mm	.230" 5.9mm	
2120	.870" 22.1mm	1.510" 38.4mm	1.962" 49.8mm	1.250" 31.8mm	.250" 6.4mm	#67 (5/8" Bolt)
2121	.500" 12.7mm	.875" 22.2mm	1.00" 25.4mm	1.025" 26mm	.125" 3.2mm	

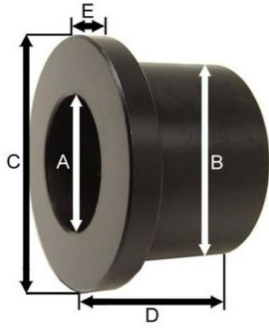

NOTE: When Measuring What Size Bushing You Need Please Use A Dial Caliper When Making Your Measurements. Do Not Use A Ruler! Fractional & Millimeter Sizes Listed Are Only Estimates

*****ALL Dimensions Subject to +/- 0.015"*****

Bushing #	A Bushing I.D.	B Barrel O.D.	C Flange OD	D Length	E Flange Thickness	Sleeve
2122	1/2" .500" 12.7mm	3/4" .750" 19mm	1.0" 1.019" 25.9mm	1.0" 1.0" 25mm	1/8" .125" 3.2mm	
2123	3/4" .750" 19mm	1-1/2" 1.510" 38.4mm	2" 1.975" 50.2mm	1-5/32" 1.157" 29.4mm	13/64" .207" 5.3mm	#10 (1/2" Bolt) #322 (9/16" Bolt)
2130	.750" 19mm	1.510" 38.4mm	1.962" 49.8mm	.942" 23.9mm	.207" 5.3mm	
2134	.875" 22.2mm	1.758" 44.7mm	2.178" 55.3mm	.850" 21.6mm	.250" 6.4mm	#188 (9/16" Bolt)
2139	.694" 17.6mm	1.129" 28.7mm	1.460" 37.1mm	1.757" 44.6mm	.125" 3.2mm	
2141	3/4" .750" 19mm	1-1/2" 1.50" 38mm	1-7/8" 1.875" 47.6mm	1-1/8" 1.130" 28.7mm	3/16" .188" 4.8mm	#354 (1/2" Bolt)
2142	.750" 19mm	1.775" 45.1mm	2.183" 55.6mm	1.130" 28.7mm	.255" 6.5mm	
2145	.625" 15.9mm	1.00" 25.4mm	1.359" 34.5mm	.525" 13.3mm	.125" 3.2mm	
2146	.812" 20.6mm	1.250" 31.8mm	1.756" 44.6mm	1.00" 25.4mm	.250" 6.4mm	
2149	.750" 19mm	1.755" 44.6mm	2.397" 60.9mm	.813" 20.7mm	.128" 3.3mm	
2150	.625" 15.9mm	1.013" 25.7mm	1.403" 35.6mm	1.144" 29mm	.184" 4.7mm	

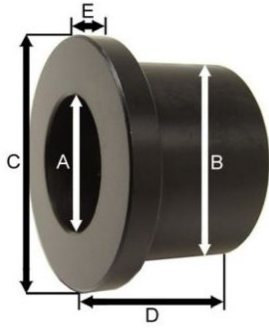

NOTE: When Measuring What Size Bushing You Need Please Use A Dial Caliper When Making Your Measurements. Do Not Use A Ruler! Fractional & Millimeter Sizes Listed Are Only Estimates

*****ALL Dimensions Subject to +/- 0.015"*****

Bushing #	A Bushing I.D.	B Barrel O.D.	C Flange OD	D Length	E Flange Thickness	Sleeve
2152	.569" 14.5mm	1.040" 26.4mm	1.330" 33.8mm	1.050" 26.7mm	.200" 5.1mm	
2154	.875" 22.2mm	1.990" 50.6mm	2.421" 61.5mm	1.725" 43.8mm	.255" 6.5mm	
2156	.750" 19mm	1.765" 44.8mm	2.180" 55.4mm	1.125" 28.6mm	.295" 7.5mm	
2165	.812" 20.6mm	1.600" 40.6mm	1.998" 50.8mm	1.937" 49.2mm	.218" 5.5mm	
2169	.750" 19mm	1.248" 31.7mm	1.650" 41.9mm	1.709" 43.4mm	.235" 6mm	
2171	.867" 22mm	1.282" 32.6mm	1.635" 41.5mm	1.708" 43.4mm	.258" 6.6mm	
2176	.745" 18.9mm	1.625" 41.3mm	2.035" 51.7mm	1.30" 33mm	.240" 6.1mm	
2180	.500" 12.7mm	1.00" 25.4mm	1.302" 33.1mm	1.540" 39.1mm	.340" 8.6mm	
2185	.870" 22.1mm	2.492" 63.3mm	3.017" 76.6mm	1.480" 37.6mm	.250" 6.4mm	
2189	1/2" .490" 12.5mm	7/8" .876" 22.3mm	1-3/16" 1.221" 31mm	1-1/8" 1.188" 30.2mm	1/4" .250" 6.4mm	
2212						

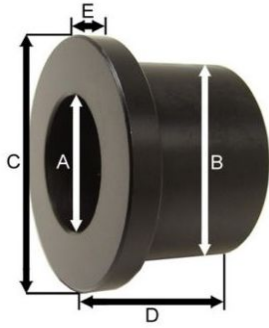

NOTE: When Measuring What Size Bushing You Need Please Use A Dial Caliper When Making Your Measurements. Do Not Use A Ruler! Fractional & Millimeter Sizes Listed Are Only Estimates

*****ALL Dimensions Subject to +/- 0.015"*****

Bushing #	A Bushing I.D.	B Barrel O.D.	C Flange OD	D Length	E Flange Thickness	Sleeve
2223	.730" 18.6mm	1.515" 38.5mm	1.95" 49.5mm	1.460" 37.1mm	.250" 6.4mm	#45 (1/2" Bolt) #08 (9/16" Bolt)
2224	.750" 19mm	1.250" 31.6mm	1.777" 45.1mm	1.455" 37mm	.235" 6mm	
2225	.491" 12.5mm	1.007" 25.6mm	1.343" 34.1mm	1.191" 30.3mm	.252" 6.4mm	
2226	.496" 12.6mm	1.001" 25.4mm	1.335" 33.9mm	1.459" 37.1mm	0.248" 6.3mm	
2233	.872" 22.2mm	1.762" 44.8mm	2.195" 55.8mm	1.750" 44.5mm	.500" 12.7mm	#106 (5/8" Bolt)
2238	.747"	1.974"	2.391"	1.123"	.331"	
2239						
2255	.874" 22.2mm	1.793" 45.6mm	2.271" 57.7mm	1.199" 30.5mm	.323" 8.2mm	
2271	.753" 19.1mm	1.302" 33.1mm	1.566" 39.8mm	.687" 17.6mm	.176" 4.6mm	
2272	.646" 16.4mm	1.607" 40.9mm	1.991" 50.6mm	.932" 23.7mm	.168" 4.3mm	
2282	.747" 19mm	1.268" 32.1mm	1.505" 38.2mm	.850" 21.6mm	.200" 5.1mm	

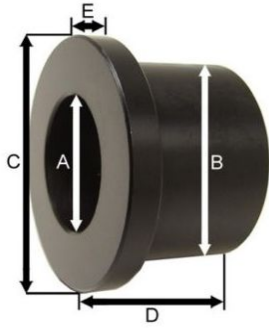

NOTE: When Measuring What Size Bushing You Need Please Use A Dial Caliper When Making Your Measurements. Do Not Use A Ruler! Fractional & Millimeter Sizes Listed Are Only Estimates

*****ALL Dimensions Subject to +/- 0.015"*****

Bushing #	A Bushing I.D.	B Barrel O.D.	C Flange OD	D Length	E Flange Thickness	Sleeve
2301	.753" 19.2mm	1.424" 36.2mm	1.740" 44.2mm	.726" 18.4mm	.335" 8.5mm	
2307	.749" 19mm	2.00" 50.8mm	2.512" 63.8mm	1.410" 35.8mm	.239" 6.1mm	#45 (1/2 Bolt) #08 (9/16" Bolt)
2308	.745" 18.9mm	1.126" 28.6mm	1.519" 38.6mm	.902" 22.9mm	0.157" 4mm	#273 (1/2" Bolt)
2369	.953" 24.2mm	2.008" 51mm	2.352" 59.7mm	2.412" 61.3mm	.312" 7.9mm	
2404	.498" 12.6mm	.748" 19mm	1.0" 25mm	.807" 20.5mm	.140" 3.5mm	
4902	.677" 17.2mm	1.157" 29.4mm	1.560" 39.6mm	.628" 16mm	.174" 4.4mm	
7028	.755" 19.2mm	1.071" 27.2mm	1.507" 38.3mm	.865" 22mm	.228" 5.8mm	
9001	.740" 18.8mm	1.124" 28.5mm	1.359" 34.5mm	0.665" 16.9mm	.179" 45.5mm	#03 (1/2" Bolt) #42 (9/16" Bolt)
9002	.744" 18.9mm	1.252" 31.8mm	1.630" 41.4mm	.846" 21.5mm	.219" 5.5mm	#04 (1/2" Bolt) #05 (9/16" Bolt) #192 (5/8" Bolt)
9072	.820" 20.8mm	1.131" 28.7mm	1.375" 34.9mm	.852" 21.6mm	.139" 3.5mm	#199 (5/8" Bolt)

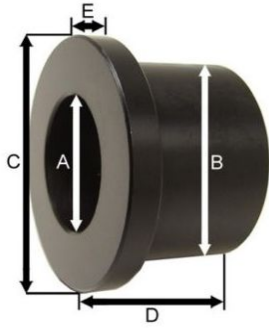

NOTE: When Measuring What Size Bushing You Need Please Use A Dial Caliper When Making Your Measurements. Do Not Use A Ruler! Fractional & Millimeter Sizes Listed Are Only Estimates

*****ALL Dimensions Subject to +/- 0.015"*****

Bushing #	A Bushing I.D.	B Barrel O.D.	C Flange OD	D Length	E Flange Thickness	Sleeve
10032	.870" 22.1mm	1.297" 33mm	1.481" 37.6mm	.611" 15.5mm	.150" 3.8mm	#395 (12mm Bolt) #508 (14mm Bolt)
10033	.873" 22.2mm	1.340" 34mm	1.572" 39.9mm	1.354" 34.4mm	.284" 7.2mm	#396 (5/8" Bolt)
02P02843	.873" 22.2mm	1.590" 40.4mm	1.965" 50mm	1.387" 35.2mm	.265" 6.7mm	#197 (5/8" Bolt)
02P02985	.747" 19mm	1.503" 38.2mm	1.63" 41.4mm	1.385" 35.2mm	.180" 4.6mm	#07 (9/16" Bolt)

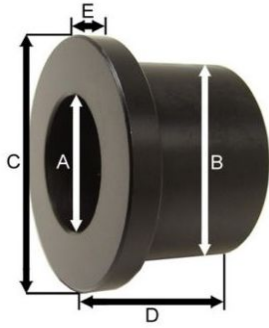

NOTE: When Measuring What Size Bushing You Need Please Use A Dial Caliper When Making Your Measurements. Do Not Use A Ruler! Fractional & Millimeter Sizes Listed Are Only Estimates

*****ALL Dimensions Subject to +/- 0.015"*****

Bushing #	A Bushing I.D.	B Barrel O.D.	C Flange OD	D Length	E Flange Thickness	Sleeve
60125	.870" 22.1mm	2.07" 52.6mm	2.358" 60mm	1.50" 38.1mm	.263" 6.7mm	#34 (5/8" Bolt)
60127	.870" 22.1mm	1.508" 38.3mm	1.854" 47.1mm	1.495" 38mm	.258" 6.6mm	#34 (5/8" Bolt)
60128	.510" 13mm	.892" 22.7mm	1.335" 33.9mm	1.422" 36.1mm	.214" 5.4mm	
60129	.573" 14.7mm	1.115" 28.3mm	1.332" 33.8mm	1.423" 36.2mm	.217" 5.5mm	
60250	.880" 22.4mm	1.380" 35.1mm	1.756" 44.8mm	1.750" 44.6mm	.275" 7mm	#130 (9/16" Bolt)
60310	.753" 19.1mm	1.508" 38.3mm	2.04" 51.8mm	1.474" 37.4mm	.269" 6.8mm	#07 (9/16" Bolt)
60311	.753" 19.1mm	1.760" 44.7mm	2.211" 56.2mm	1.502" 38.2mm	.275" 7mm	#45 (1/2" Bolt) #08 (9/16" Bolt) #60791 (5/8" Bolt)
60348	.753" 19.1mm	1.140" 29mm	1.405" 35.7mm	.692" 17.6mm	.183" 4.7mm	#03 (1/2" Bolt) #42 (9/16" Bolt)
60349	.753" 19.1mm	1.256" 31.9mm	1.643" 41.7mm	.851" 21.6mm	.237" 6mm	#04 (1/2" Bolt) #05 (9/16" Bolt) #192 (5/8" Bolt)
66062	.626" 15.9mm	1.011" 25.7mm	1.387" 35.2mm	.738" 18.6mm	.325" 8.3mm	#60735 (1/2" Bolt)